



# HYDRA SPA

## INSTALLATION PROCEDURE

---



- Drill-Free design, needs no tools and it's quick and easy to install
- 3 Way diverter allows the rain head and hand held shower to operate simultaneously or each individually
- 8" Powerful pressure boosting oxygenated rain head
- 5" - 5 function handheld shower head gives you the versatility of a rain spray, massage spray, rain and massage spray, high pressure dot massage, massage and dot massage combo
- 6 inch stainless steel shower arm height adjustable shower head with 34" bar
- 60" shower hose
- Shower head: 7 LPM
- Hand held shower: 6.6 LPM
- Chrome Finish
- Soap dish
- Anti calcium microjets

**Meets CSA Standard.** Meets WaterSense Standard  
Package includes: 34 inch long drill-free slide bar, brass tube, 6" brass shower arm, suction cup, one hand held and one fixed shower head, soap dish.



# HYDRA SPA

## INSTALLATION PROCEDURE

### Faucet Installation

#### ASSEMBLING TOOLS

Teflon tape



Wrapped wrench or  
Strap to avoid  
scratches

Shut off the water supply valves.

Use Teflon tape on all threaded connections

1

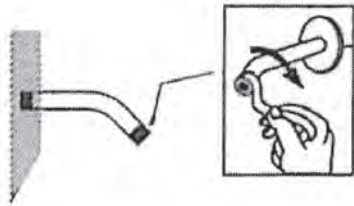

#### 1. Shower arm installation

Apply Teflon tape to threads of shower arm

2

#### 2. Slide bar installation

Thread shower head arm to top of shower rail. Attach back flow preventer to bottom of the 3 way diverter. Place washer into nut.



3

#### 3. Slide bar installation

Attach slide bar to the shower arm by rotating nut by hand first then snug with wrench

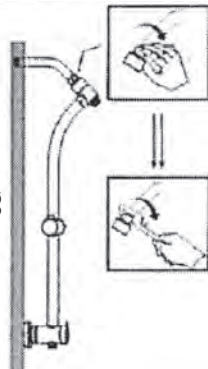

4

#### 4. Slide bar to the wall installation

Attention: The wall must be clean and dry. Do not pull out violently

4.1

#### 4.1 Suction cup for smooth wall surface

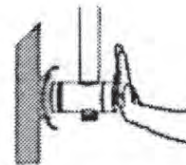

Firmly press diverter against wall surface until it is properly secured

4.2

#### 4.2 Adhesive pad for uneven wall surface



Place adhesive ring on suction cup, once desired position has been found, remove protective seal from adhesive backing and firmly press diverter against the wall.



# HYDRA SPA

## INSTALLATION PROCEDURE

### Faucet Installation

#### ASSEMBLING TOOLS

Teflon tape



Wrapped wrench or  
Strap to avoid  
scratches

**Shut off the water supply valves.  
Use Teflon tape on all threaded connections**

**5**

#### 5. Shower installation

Put washer into shower hose flex nut. Connect the shower hose hex nut to the 3 way back flow preventer

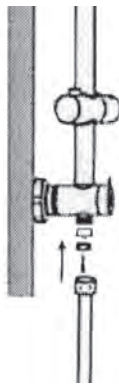

**6**

#### Shower Head & Hand held installation

Put washer into conical nut. Connect the shower hose conical nut to the handheld shower. Connect 8" shower head to top of shower rail assembly.

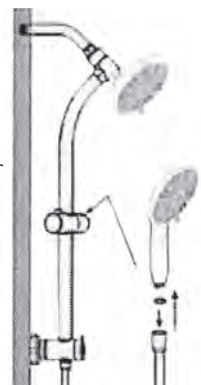

**7**

**Enjoy your new Hydra Spa!!!!**

Your Hydra Spa has been designed and engineered to compensate for slight differences in shower arm angles during installation. On occasion the brass ball shower arm connection has been pushed into the shower rail bar causing the connector to be loose. Should this happen during installation, loosen the ball joint coupling nut, seat the "O" ring and re-tighten to ensure enjoyment of your Hydra Spa for years to come.

#### KANREP NORRIS DISTRIBUTION

42 Keefer Court, Unit 8, Hamilton, ON L8E 4V4, Canada  
Tel. +1.800.793.2793 Tel. 905.578.4505 Fx +1.800.315.4452 Fx 905.578.1040