



PRODUCT *Instructions*

KN140 - Classic Widespread Bathroom Tap Set



The Loo Store

Grimsby, Ontario, Canada

1-877-290-3445

info@theloostore.com

www.theloostore.com

KN140 - Classic Widespread Bathroom Tap Set

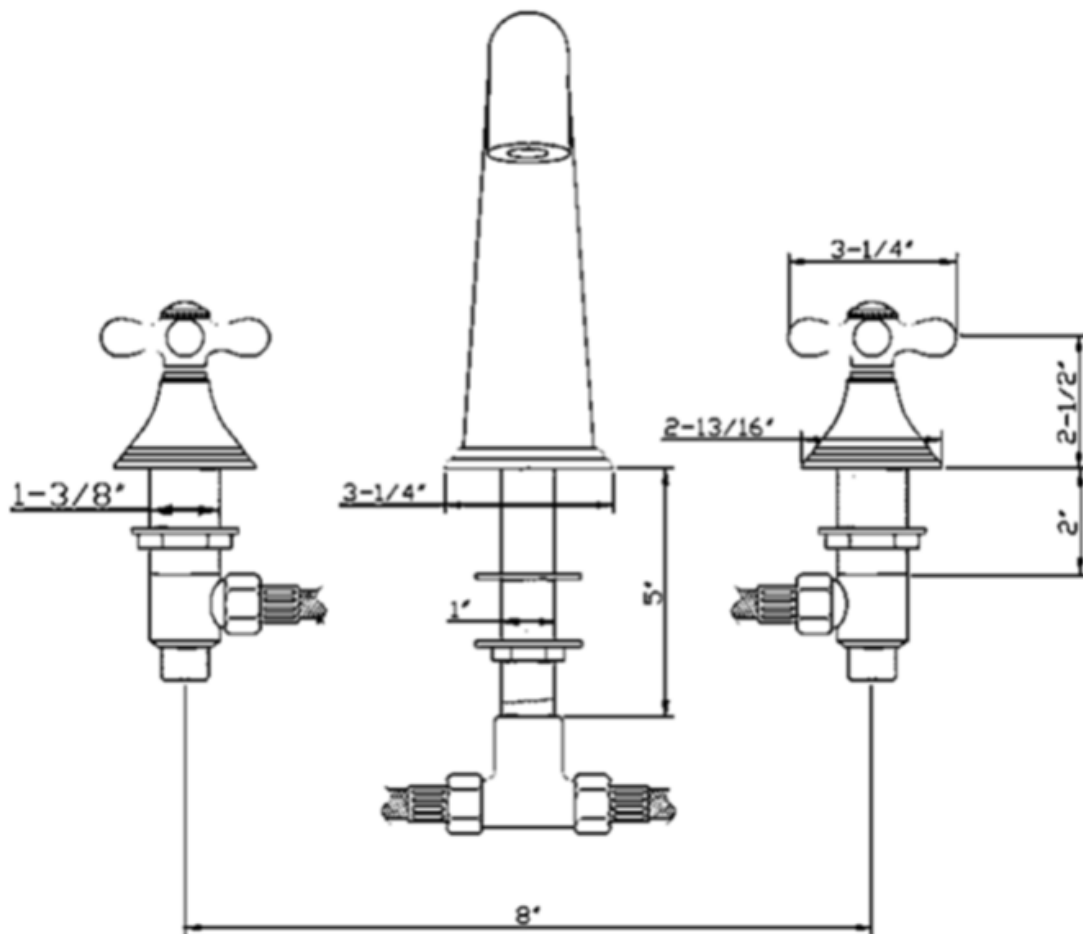

Care and Maintenance

Minimum maintenance is required to maintain product finish. With proper maintenance your Rubex faucet will continually look like new. Special care should be taken when cleaning your faucet and the following suggestions will help extend your faucet life

- A. Cleaning should be done regularly using a soft cotton cloth and warm water; then towel dry
- B. Do not use cleaners that contain abrasives or harsh chemicals ;care should be taken in selecting cleaning supplies. Many cleaners contain detergents, ammonia, or other corrosive solvents that could damage your faucet finish.
- C. Occasionally clean with a non-abrasive wax polish

Warranty

Kanrep Norris warrants the original purchase for a LIMITED LIFE TIME from original purchase that the product will be free of any manufacturing defects. Product will be replaced at no charge provided it has been installed in accordance to the attached installation instruction, used as recommended and not damaged due to misuse, abuse, faulty maintenance, accident, or other damage. Kanrep Norris is not responsible for replacement labour costs, or shipping charges, or damage incurred during installation, transportation, removal, repair, or replacements. All warranty claims are to be made to info@kanrep.ca and shall be accompanied by the original purchase receipt and photographs of the damage.

Installation Instructions

Widespread Lavatory Faucet

Warranted only if installed by a qualified licensed plumber. Use Teflon tape on all threaded connections.

1. Shut off the water supply valves before installation.
2. Insert spout shank through the spout ring, if your set came with one, and the center hole. Place washer on spout with nut. Hand tighten, align spout and wrench tighten.
3. Crosshandled sets have two like valves. Place the bottom lock down nut and thin washer onto valve body. Then, from the underside, insert valve bodies through deck and hand tighten the top hold down nut and thin washer cup onto the valve body. Place the escutcheon onto the stem and adjust the vertical height of the valve stem with the hold down nuts. The distance from the bottom of the handle to the top of the escutcheon should be 1/8" when the valve is off. Wrench tighten the hold down nuts.
4. Place the escutcheon on the stem and tighten.
5. Assemble the tee to spout shank with washers and seals as shown. Wrench tighten.

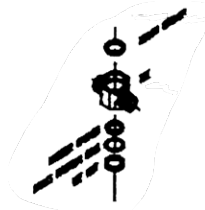

6. Attach supply lines to bottom of valves. Wrench tighten.
7. Connect the stainless steel flex lines to the valve bodies and the tee. Wrench tighten until sealed.
8. Unscrew the flange from the pop-up body. Insert the pop-up body through the sink drain hole and hand tighten the flange to the body. With the ball rod facing towards the back, wrench tighten the lock nut. Insert the pop-up plunger through the collar.
9. Insert the pop-up rod with knob through the faucet pop-up hole. Insert the pop-up rod through the strap. Adjust for best operation and tighten the set screw.
10. Turn on the water supply. Remove the aerator from the end of the spout and flush hot and cold lines until the water is clear. Attach the aerator and enjoy your beautiful faucet.
11. Make no adjustments to valves or valve stems. They are tested at the factory for optimum performance.